

HK-33.S

SIZE: 2200x2435x2590mm

Color- RAL 5010

Frame- Steel profiles of 3mm thickness

Walls

10mm - Zink coated trapezial metal sheet - T8 (0,55mm)

60mm - Thermal insulation A1

0,2mm - Vapor barrier- PE foil

10mm - Double-sided laminated chipboard E1 White

Roof

45mm - Zinc coated trapezial metal pl. painted-T35(0,75mm)

100mm - Thermal insulation A1

0,2mm - Vapor barrier

10mm - Double-sided laminated chipboard E1 White

Floor

0,55mm - Zinc coated steel sheet

100mm - Thermal insulation A1

0,2mm - Vapor barrier- PE foil

20mm - Cetriss

2,5mm - Floor covering PVC gray marble

Electricity

Wiring in the walls, CYKY

Switch (1x)

Sockets(2x) Schucko

Fluorescent lamps 2x36W (1x)

Electrick switchboard

Convector Stiebel eltron 0,7kW-1x

Ventilator - 2x

Doors :

MZ-875x2000 with window RAL 5010- (1x)

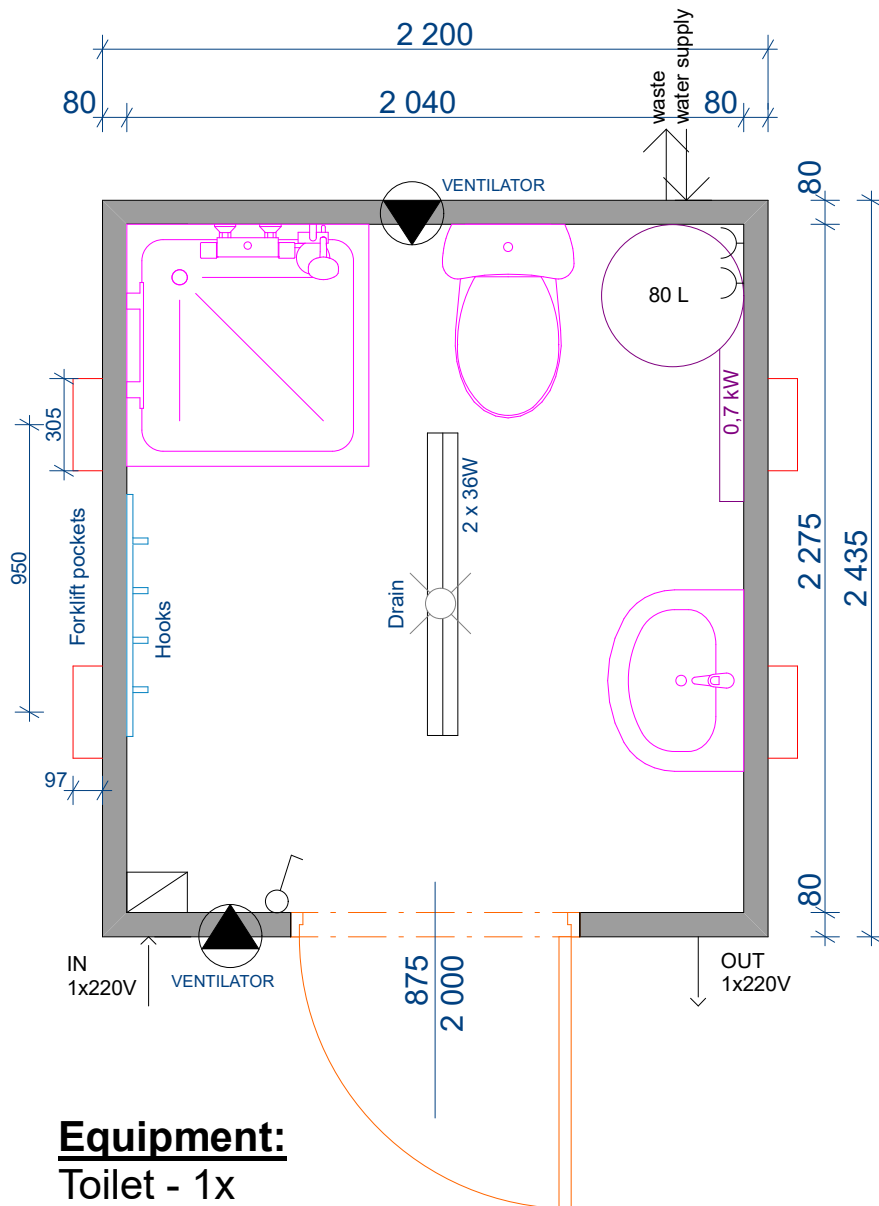

Equipment:

Toilet - 1x

Washbasin 600 - 1x

Shower 80x80 - 1x

Waterheater 80L - 1x

Drain in the floor - 1x

Hooks - 4x